



RESTOR TANKING MIX

FUNCTION

Slurry applied treatment used in the control of lateral penetration of water in walls below ground level. RESTOR TANKING MIX is not sulphate resisting.

COMPOSITION

Portland cement, finely graded aggregates and chemical modifiers, plus an acrylic polymer.

DESCRIPTION

Grey or white powder.

USES

Where external ground level is above internal floor level it is usually necessary to provide a barrier to penetrating moisture in conjunction with an injected dpc. In such instances RESTOR TANKING MIX may be applied directly onto brickwork. In cellars and other areas of high hydrostatic pressure and where there could be sulphate salts present it is advisable to use the RESTOR TANKING MIX in conjunction with a sulphate resisting backing render.

COVERAGE

For normal dampness one brush coat applied at the rate of 2.5 kg/sq. metre. For severe hydrostatic pressure two coats each of 2.5 kg/sq. metre giving a total of 5 kg/sq. metre. RESTOR TANKING MIX is available in white and grey for easy and effective control of each coat.

APPLICATION

Surface Preparation: The surfaces to be treated must be totally free from dust, loose material, plaster, bitumen, oil, paint etc. In particularly difficult circumstances sand blasting may be the most cost effective means of providing a clean surface for treatment. Where RESTOR TANKING MIX is to be used in conjunction with water repellent chemicals for dampcoursing, contamination of the surfaces with water repellent must be avoided prior to tanking.

Perished areas of brickwork or concrete should be cut out, down to solid structure, and any iron or steel rods cut back to at least 2cm below the surface. Uneven surfaces should be levelled with a 3:1 sand:sulphate resisting Portland cement mix which should be allowed to cure before applying RESTOR TANKING MIX

Backing Render: In cellars and other areas of high hydrostatic pressure the surface should be prepared as indicated above. The mortar joints should be raked out and, if necessary, the surface hacked to provide a sound mechanical key for the backing render. The backing render should be 3:1, washed sharp sand: sulphate resisting Portland cement (SRPC) applied to a minimum thickness of 10mm. Allow to cure for 24 hours before applying RESTOR TANKING MIX

Float Coat: Use the same mix as the backing coat with the addition of RENDERPEL as the basis for a conventional finish.

Mixing: RESTOR TANKING MIX is supplied as a powder and must be mixed with water to form a slurry for use at the rate of 7.9 litres of water to each 25kg bag. Do not attempt to prolong usable time.

Coating: RESTOR TANKING MIX must be applied to a saturated surface to ensure full effectiveness. All surfaces to be treated must be wetted thoroughly several times making sure however that no standing water remains on horizontal surfaces. The slurry should be applied to vertical surfaces using a brush or suitable spray. On horizontal surfaces use a broom. It is essential that the entire surface is covered ensuring that all crevices and irregularities are filled. Particular attention should be paid to the junction between the floor and wall (cavetto) i.e. cut out a 20mm x 20mm fillet at the wall floor junction. See Figure 1.

Figure 1

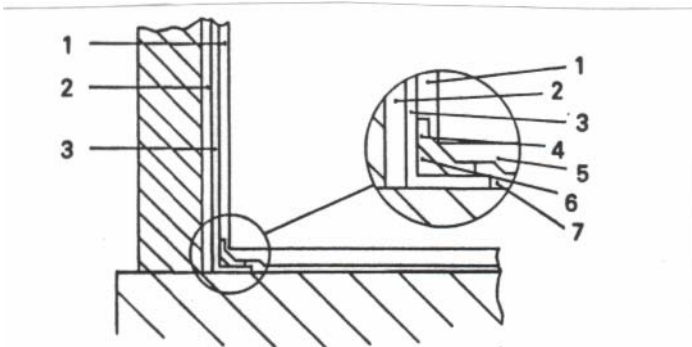

Key: 1. Float coat

2. Surface levelled with 1.3 sulphate resisting Portland cement:sand mix.
3. Vertical tanking coat of Restor Tanking Mix.
4. Cavetto tanked with Restor Tanking Mix.
5. Floor Screed.
6. Cavetto formed with 1:3 sulphate resisting Portland cement.sand mix.
7. Horizontal tanking with Restor Tanking Mix.

Curing: The coating will remain soft for about 24 hours so avoid contact during this time. Where necessary, a second coat can be applied, once the first one has begun to harden. Protect from frost, direct sunlight and drying winds for 24 hours.

Treated surfaces may be rendered after 24 hours and will become fully effective within 8 days. RESTOR TANKING MIX is not a final finish for floors which should be screeded or sealed with an abrasion resistant coating.

Fixing: Anything which disrupts the continuity of the coating will give rise to a weakness in the tanking. Wherever possible fixing of items to tanked walls should be avoided. Where fixings have to be made, provisions should be made in advance by drilling oversized holes and plugging with RESTOR-SET RAPID, then inserting plastic plugs whilst still soft or drilling a correctly sized hole after it has set. Skirtings should be glued on wherever possible. See Figure 2.

Figure 2

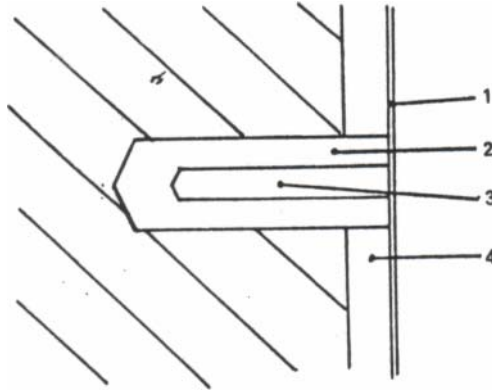

- Key:
1. Restor Tanking Mix.
 2. Restor-Set Rapid used to plug oversized holes
 3. Holes drilled in Restor Tanking Mix to take fixing plug.
 4. Surface levelled with 1:3 sulphate resisting Portland cement sand mix.

The plugging medium should be made flush with the wall and RESTOR TANKING MIX simply brushed over as normal, taking care that the plugged hole is deep enough to take the screws being used. Pipe-work passing through the walls should be sealed with silicone sealant. Holes for light switches, sockets, conduit, electrical wiring etc., should be chased out and a coat of RESTOR TANKING MIX applied to the cavity. Where extra fixtures are to be made the procedure set out above should be followed.

Handling and Storage

Avoid breathing dust

Wash hands and exposed skin after use

Wear gloves when handling and eye protection if spraying

If splashed in eyes flush with plenty of clean water.

When stored in dry conditions in unopened bags, the product should have a storage life of up to 12 months.

Disclaimer

When compiling technical data for the company's products all reasonable care is taken. It is the customers responsibility to satisfy himself that the product is fit for purpose

Product Name: RESTOR TANKING MIX

Chemical Composition:

Sand, cement and inorganic salts and alkalis.

Physical Data:

Appearance Grey or White powder.

Solubility Virtually insoluble in water.

Flammability Data:

Non-flammable.

Hazard Classification: IRRITANT POWDER

Risks: Irritating to eyes, skin and respiratory passages.

Protection:

Observe normal industrial hygiene precautions. Wear dust mask and gloves when handling.

First Aid:

Skin Wash with soap and water.

Eyes Flush immediately with clean water and seek medical attention if irritation persists.

Ingestion Wash out mouth with plenty of water.

Disposal:

Brush up and dispose of as non-hazardous solid waste.

Transport Data:

Not classed as hazardous for transport purposes.

Restoration UK Ltd
Unit 3, 18 Hanford Way
Loughborough
Leicestershire LE11 1LS
Web: www.restorationuk.com Email: info@restorationuk.com
Tel: 01509 217750